

6660⁽⁰⁾

3756⁽⁰⁾

34°17'30"

34°17'0"

91°11'30"

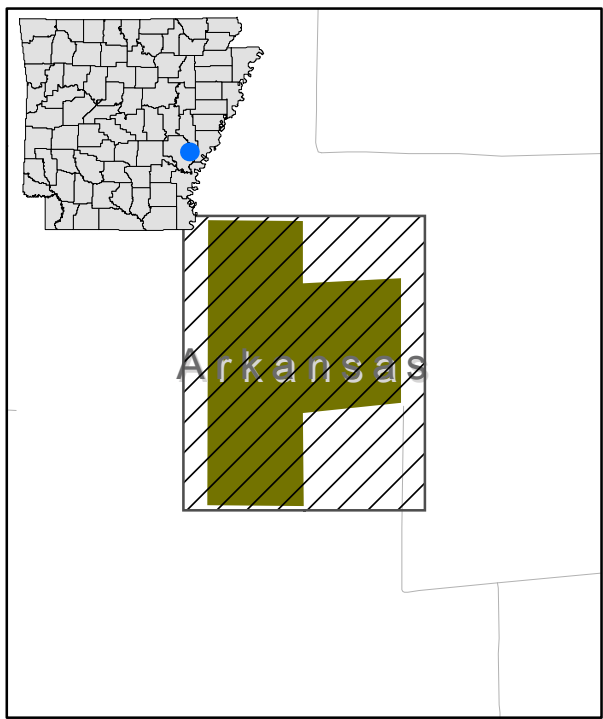
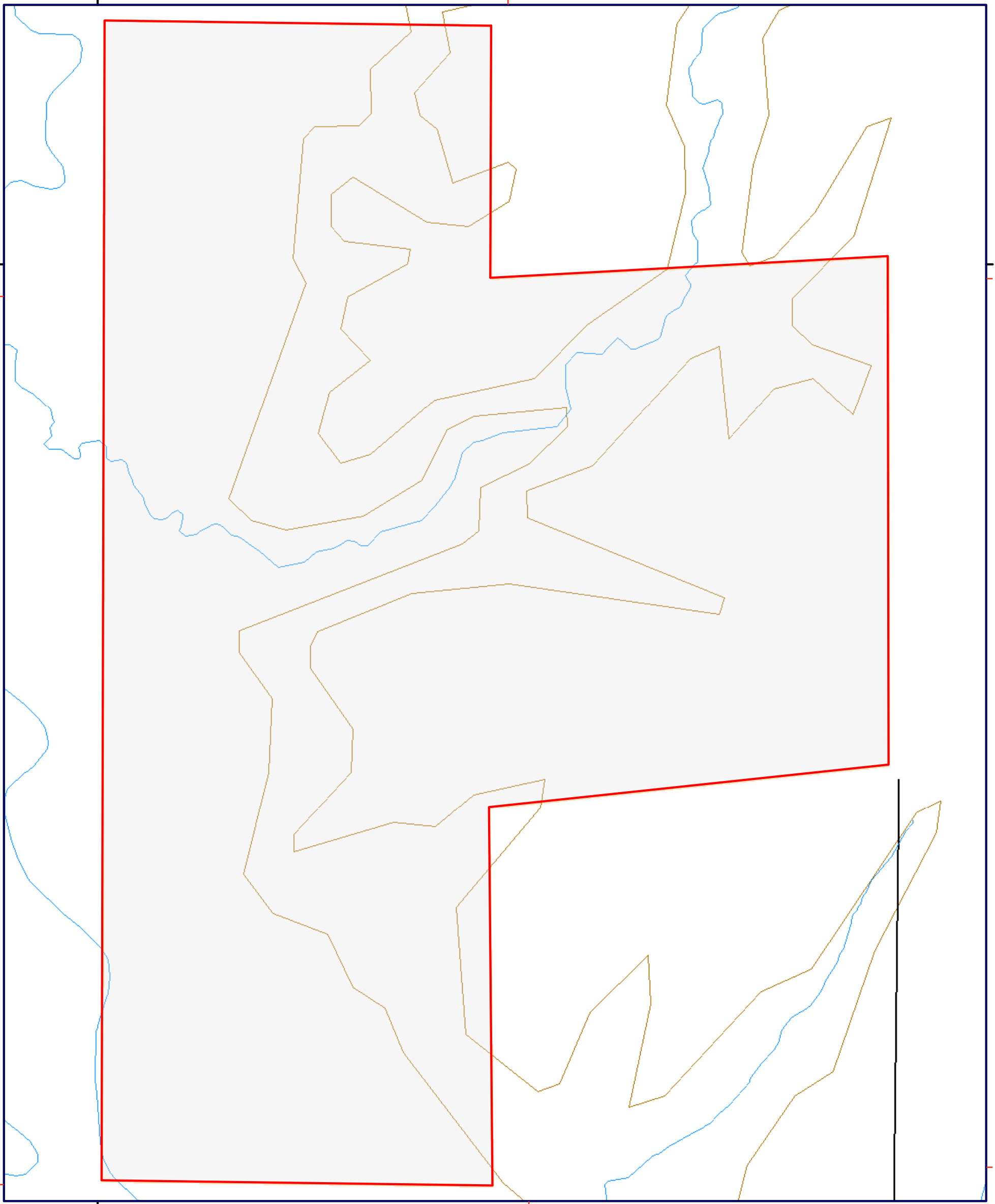

Ethel WMA

- | | | | | | |
|-------------------------|------------------------------|--------------------------------|----------------------|-------------------|-------------------|
| Waterfowl Rest Area | No Rifle Area | Wilderness Area | Office Facilities | Archery Range | Showers |
| Green Tree Reservoir | Archery Only | Wildlife Demonstration Area | WMA Facilities | Shooting Range | Bike Trail |
| Moist Soil Unit | No Dogs Allowed | Quail Demonstration Area | Education Facilities | Foot Bridge | Bank Fishing |
| Dove Fields | No Dogs, Hunting or Trapping | Quail Compartment | Hatchery | Fishing Pier | Check Station |
| Field | No Trapping Area | Quail Habitat Restoration Area | Boat Ramp | Courtesy Dock | Walking Trail |
| Food Plot | Special Regulatory Area | Field Trail Area | Boating Access | Pavilion | Visitor Center |
| Wildlife Openings | Walk In Turkey Hunting Area | WMA Property | Parking, Improved | Duck Hole | Picnic Area |
| No Hunting Area | Natural Area | | Parking | Gate | Restroom |
| | | | Camping, Fee Area | Bridge | Hand pump |
| Abandon Railroad Tram | Trail | Roads | Camping, Hook-ups | Control Structure | Point of Interest |
| Gasline | Fire Lane | Improved Road * | Camping, Primitive | | |
| Levee | Improved Road | Unimproved Road * | | | |
| Powerline | Unimproved Road | Road * | | | |
| Water Control Structure | Boat Lane | Handicap Access * | | | |

* Restricted or Seasonal Access / See Regulations

Every attempt has been made to provide accurate information about our areas. However, because of a wide range of factors, we do not guarantee the content accuracy or completeness of this map. It is intended for reference purposes only. Always consult the AGFC Guidebook and adhere to boundary signs and other on-site indicators.



0.03 Miles
1 inch = 0.06 miles